

REF UTI-1S1

Rapid Response™ Urinary Tract Infection (UTI) Test Strips

(Urine)
URINALYSIS

The Rapid Response™ Urinary Tract Infection (UTI) Test Strips are for the detection of leukocytes (white blood cells) and nitrite in urine, to aid in the screening of urinary tract infection. Save time with this simple and convenient at-home test that provides results in 1-2 minutes.

Kit Content

- 3 Individually packaged test strips (with color chart)
- 1 Product insert

Product Details

Sample: Urine

Format: Strip

Time-to-Result: 1-2 minutes

Storage Condition: 36-86°F/2-30°C

Test Principle: Colorimetric Analysis

Convenient

Quickly screen for signs of a Urinary Tract Infection at home.



Accurate

Same type of test used in most clinics to diagnose a UTI. >94% Accurate.



User-Friendly Handle

Sanitary and comfortable grip for ease of use.



Easy to Use

Test results are interpreted by comparing the test pads to the color chart provided on the back of each pouch.

For *in vitro* diagnostic use only.
OTC in Canada and U.S.

REF UTI-1S1

Urinary Tract Infection (UTI) Test Strips

Testing Procedure

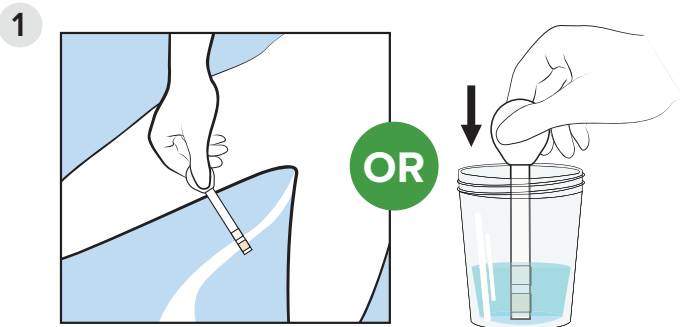

Wet test pad(s) in urine stream or dip test pad(s) into a collection container with urine for 1-2 seconds.

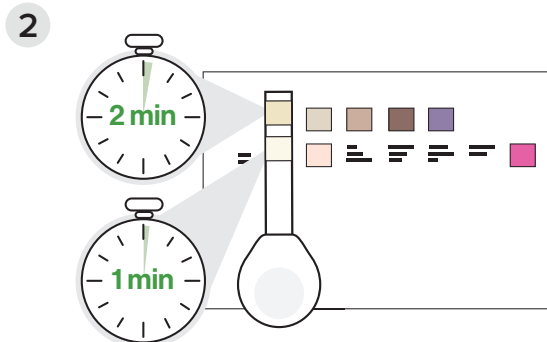



Read result at 1 minute for nitrite and at 2 minutes for leukocytes. Compare test pad(s) to color chart.

These instructions are for illustrative purposes only. Please read the instructions supplied with the test before use.

Result Interpretation

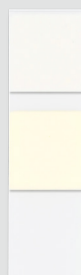
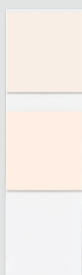

	LEU	- or ±
	NIT	-
Results suggest no sign of UTI.		
	LEU	- or ±
	NIT	+
Results suggest a sign of UTI.		
	LEU	+, ++, or +++
	NIT	- or +
Results suggest a sign of UTI.		

Ordering Information

Product Code	Product Name	Contents
UTI-1S1	Urinary Tract Infection (UTI) Test Strips	3 Tests

To learn more contact your local **Sales Representative**, call us at **+1 888 506-2658**, or email us at **info@lochnessmedical.com**

REF UTI-1S1

Urinary Tract Infection (UTI) Test Strips

Composition

The test is a firm plastic strip onto which leukocytes and nitrite test pads are attached.

Nitrite (NIT)

Read time:
1 minute

Description:
Detects sodium nitrite as low as 0.05-0.1 mg/dL in urine.

Leukocytes (LEU)

Read time:
2 minutes

Description:
Detects leukocytes as low as 9-15 Leu/ μ L in clinical urine.



Accuracy

94.4%
Leukocyte Test*
98.4%
Nitrite Test*

* The performance characteristics of the strips are based on both laboratory and clinical tests. The sensitivity of the test depends upon several factors: the variability of color perception; the presence or absence of inhibitory factors; and the lighting conditions under which the strip is read.

Ordering Information

Product Code	Product Name	Contents
UTI-1S1	Urinary Tract Infection (UTI) Test Strips	3 Tests

To learn more contact your local **Sales Representative**, call us at **+1 888 506-2658**, or email us at **info@lochnessmedical.com**